

LPF7045 Series



http://www.abco.co.kr

SMD Shielded type

▼ Shape & Dimensions / Recommended Solder Land Pattern

(Dimensions in mm)

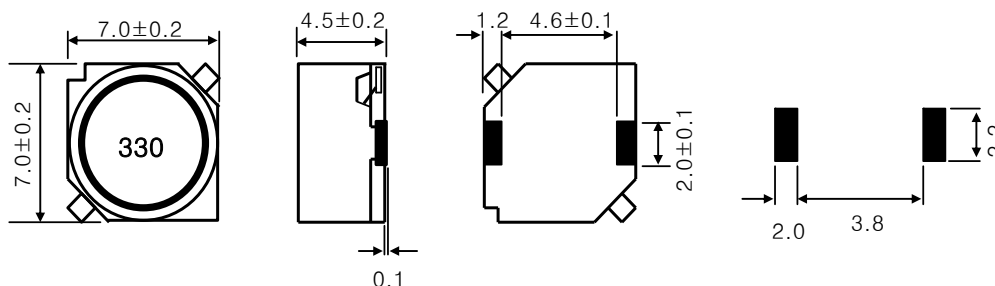

▼ Electrical Characteristics

Ordering Code	Inductance		Freq.	DC Resistance(Ω)	Rated DC current(A)	
	L (uH)	Tol. (%)	F (KHz)	Rdc (±20%)	Idc1 (Max.)	Idc2 (Typ.)
LPF7045T-1R2M	1.2	±20	100	0.0105	5.00	4.20
LPF7045T-2R2M	2.2			0.0190	3.00	3.40
LPF7045T-3R3M	3.3			0.0220	2.50	3.20
LPF7045T-3R9M	3.9			0.0250	2.40	3.00
LPF7045T-4R7M	4.7			0.0280	2.30	2.80
LPF7045T-6R8M	6.8			0.0390	1.90	2.04
LPF7045T-100M	10			0.0400	1.80	1.81
LPF7045T-150M	15			0.0560	1.50	1.50
LPF7045T-220M	22			0.0700	1.30	1.30
LPF7045T-330M	33			0.1100	1.10	1.11
LPF7045T-470M	47			0.1700	0.90	0.93
LPF7045T-680M	68			0.2800	0.75	0.76
LPF7045T-101M	100			0.3500	0.60	0.61
LPF7045T-151M	150			0.4800	0.50	0.54
LPF7045T-221M	220			0.7500	0.40	0.43
LPF7045T-331M	330			1.1000	0.35	0.37
LPF7045T-471M	470	1.4000	0.27	0.27		
LPF7045T-681M	680	2.1000	0.23	0.23		

▼ Test Equipments

- . L : Agilent E4980A Precision LCR Meter
- . Rdc : HIOKI 3540 mΩ HiTESTER
- . Idc1 : Agilent 4284A LCR Meter + Agilent 42841A Bias Current Source
- . Idc2 : Yokogawa DR130 Hybrid Recorder + Agilent 6692A DC Power Supply

Packing style

T : Taping B : Bulk

▼ Test Condition

- . L(Frequency , Voltage) : F=100 (KHz) , V=0.5 (V)
- . Idc1(The saturation current) : $\Delta L \leq 10\%$ reduction from initial L value
- . Idc2(The temperature rise): $\Delta T = 20^\circ\text{C}$ typical at rated DC current
- * Rated DC current(Idc) : The value of Idc1 or Idc2 , whichever is smaller

▼ Operating Temperature Range

-20 ~ +85°C (Including self-generated heat)